

PLAN SHOWING BUILDING LOCATION ON PART OF LOT 9, CONCESSION IV. (FORMERLY TOWNSHIP OF MATTAWANAGA) VILLAGE OF CREAMORE, COUNTY OF SIMCOE

SCALE 1:500
ZUBEK, EMO AND PATTEN LTD.
1983

CAUTION THIS PLAN IS PREPARED FOR
MORTGAGE PURPOSES ONLY AND DOES NOT FULLY
ACCORD WITH THE REQUIREMENTS OF THE REGISTRY
ACT AND THE SURVEYS ACT

METRIC
THE MEASUREMENTS SHOWN ON THIS PLAN ARE IN
METERS AND MAY BE CONVERTED TO FEET BY
DIVIDING BY 0.3048

I HEREBY CERTIFY THAT
THIS PLAN IS CORRECT

[Signature]
RONALD J. EMO
ONTARIO LAND SURVEYOR
COLLINGWOOD

JAN. 17, 1983

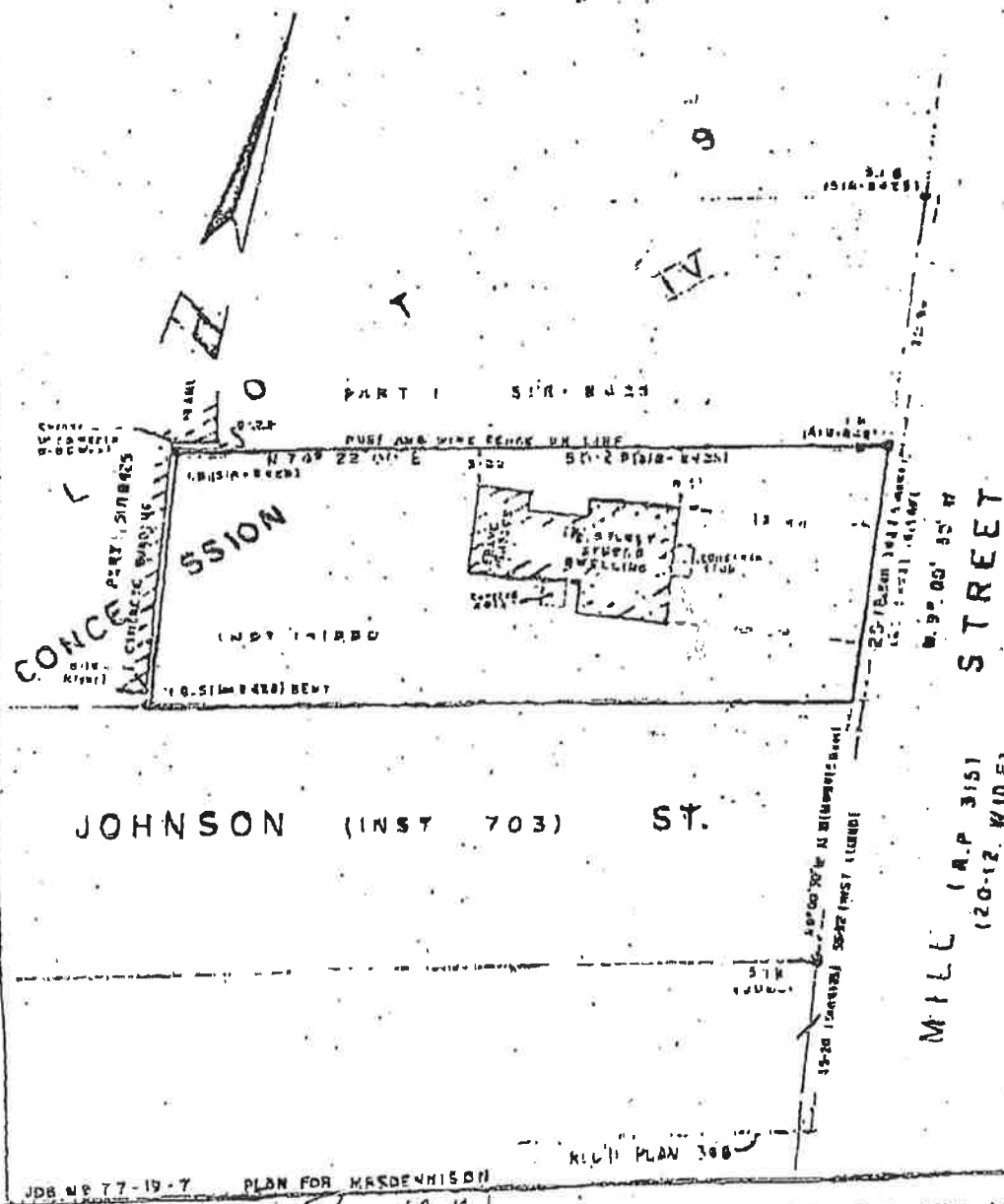

JDB NO 77-19-7

PLAN FOR MARDENHISON

KILL PLAN 300

[Signatures]
S. J. Jiles